

User Manual

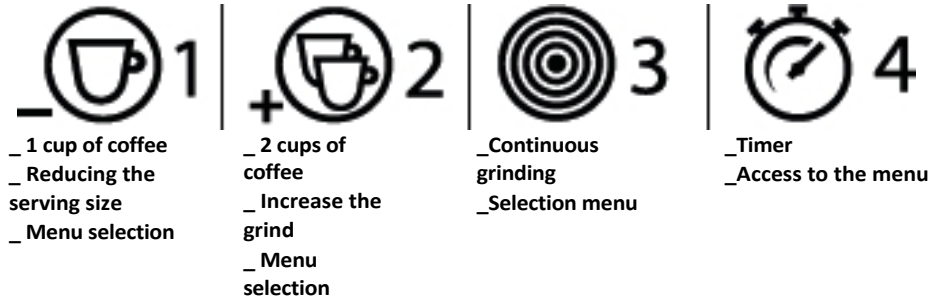

STARTING UP THE GRINDER:

Connect the coffee grinder to the power supply and turn it on by pressing the main switch.

Language selection: Press button 4 twice to access the language menu. Then press buttons 1 and 2 simultaneously for 4 seconds. (LANGUAGE)(1-BEAT- 1 COFFEE)(2-BEATS-2 COFFEES) (COUNTER)

Press buttons 1 or 2 to select the language until the desired language is displayed.

Once selected, no confirmation is required.

1 coffee: Press button 1 to dispense one serving of ground coffee.

2 coffees: Press button 2 to get two doses of ground coffee.

Continuous Grinding (custom dose): Press button 3 until you obtain the desired amount of ground coffee.

Program Coffee: To access the programming menu for 1 or 2 coffees, press button 4 twice, then press buttons 1 and 2 simultaneously for 4 seconds. Press button 3 to select the option.

(LANGUAGE)(1-BEAT- 1 COFFEE)(2-BEATS-2 COFFEES) (COUNTER)

Press button 1 (decrease) or button 2 (increase) to change the grind setting.

Coffee Counter: To access the coffee counter settings, press button 4 twice, then press buttons 1 and 2 simultaneously for 4 seconds. Press button 3 to select the option.

(LANGUAGE)(1-BEAT- 1 COFFEE)(2-BEATS-2 COFFEES) (COUNTER)

View the amount of coffee on the screen.

The counter will be reset to zero by pressing buttons 1 and 2 simultaneously.

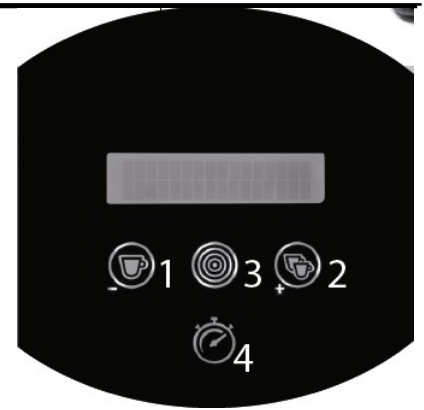

GRIND SETTING ACCORDING TO THE COFFEE MACHINE

How to make the perfect espresso: press button 4 on the coffee grinder with one hand. With the other hand, press the coffee button on the coffee machine at the same time. Once the coffee is made, press button 4 to stop the timer and see the seconds it takes to make a cup of coffee. The calibration will be adjusted according to the table below. 15"-20": (Very

coarse grind): Incorrect coffee.

20"-25": (Fine grind): Correct coffee.

25"-30": (Very fine grind): Incorrect coffee.

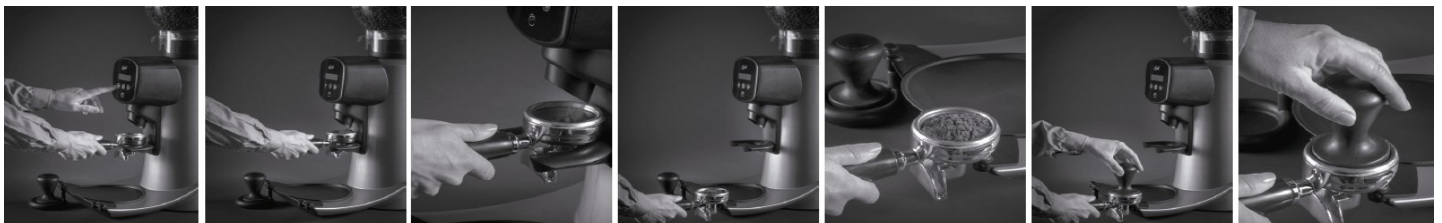
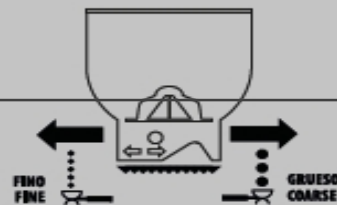

Select the dose: Place the coffee holder on the wedge to fill it with the selected ground coffee.

The holder is positioned at the bottom of the grinder (as shown *) when filled with ground coffee. The press is used to ensure proper compaction.

* Adjust to the right or left according to the barista



GGM Gastro International GmbH
Weinerpark 16
D-48607 Ochtrup

www.ggmgastro.com info@ggmgastro.com
+49 2553 7220 0